

Quick Start



Turning on the Autoclave



★ Fill Water

If this icon appears please fill water.



▲ Use mineral free water only.
(green water tap)



★ Fill Water

During the filling make sure that the water **does not reach the Red Area**.

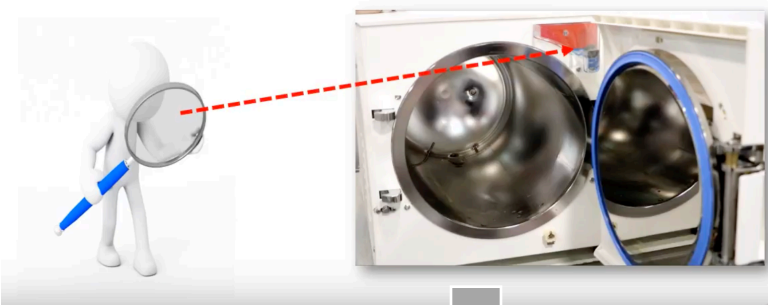

★ Temperature Sensors

Temperature sensors must be inside the bottles.

In case there is more than one bottle, place the two temperature sensors into two separate liquid containers.



▲ For proper sterilization, fill the bottles with approximately the same amount of liquid.

Preparing the Autoclave for Operation

Select the program using the "UP" or "DOWN" arrows.

(Programs can only be selected when the door is open).



Liquid A - cooling

- 15 min @121°C
- Fast cooling

Liquid B waste - cooling

- 30min@121°C
- Fast cooling

Liquid A

- 15min @121°C
- slow cooling

Glass

- 3min @134°C

Plastics

- 15min @121°C

Door Closure

Hold the handle and push



Do not squeeze the sensor cables with the door



Start Cycle

Press the **START/STOP** key to start the cycle

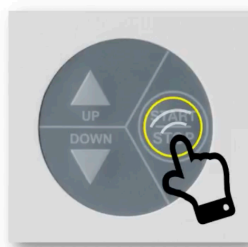

Cycle

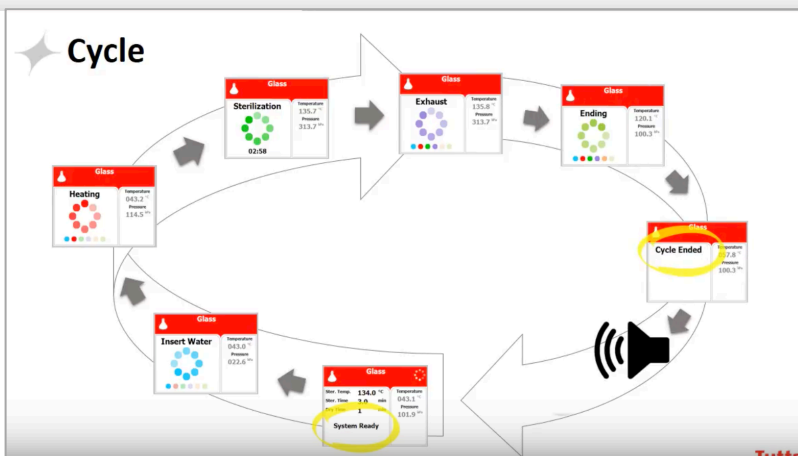

End of Cycle



Press **START/STOP** key once to confirm

Open the Door



Caution!
The bottles might be hot.
Use heat – resistant gloves



Do not squeeze the Sensor cables with the door

VERY IMPORTANT



AGAR SPILL

Do the following **while autoclave is still warm**

- Remove all agar from chamber
- Empty water tank (see next page)
- Fill water tank with mineral free water
- Run Liquid A –Cooling program
- When program is done, exchange water in tank once more

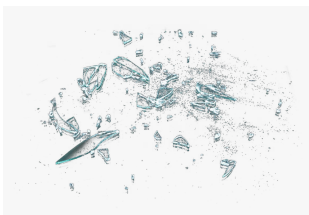

BROKEN GLASS

Vacuum clean the chamber- especially around the holes in the back wall.

Call us
Martina 07221-79800
or Per 076-850 44 27

Connect the tube to the outlet to drain the tank

